



# 11 Longmead Avenue

, Bristol, BS7 8QB

£4,770 Per month



\*\* Student Property - Academic Year 2026 - Prime Location \*\*

Airsat Real Estate are delighted to bring to market this spacious six double bedroom student property in a very sought after prime location in Bishopston area ideally located in the middle of very popular Gloucester Road close to all local amenities including restaurants, cafes, pubs and supermarkets.

This large Victorian character house is arranged over two floors and briefly comprises 6 double bedrooms all of a similar size.

Bedrooms with small double bed, wardrobe, chest of drawers, notice board, desk and chair.

Two new shower rooms, a large sociable kitchen/communal area.





- Lounge
- Kitchen
- Room 1
- Room 2
- Room 3
- Room 4
- Room 5
- Room 6
- Bathroom 1
- Bathroom 2

Area Map

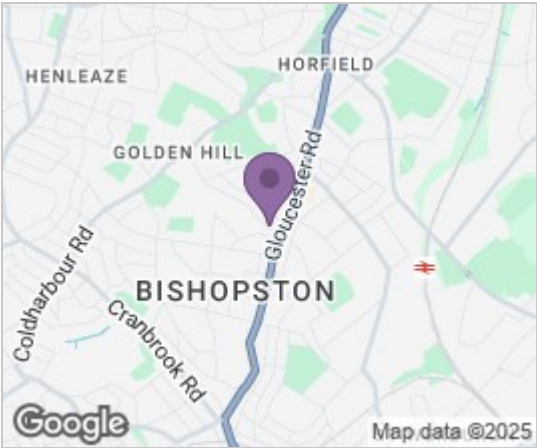

Floor Plans

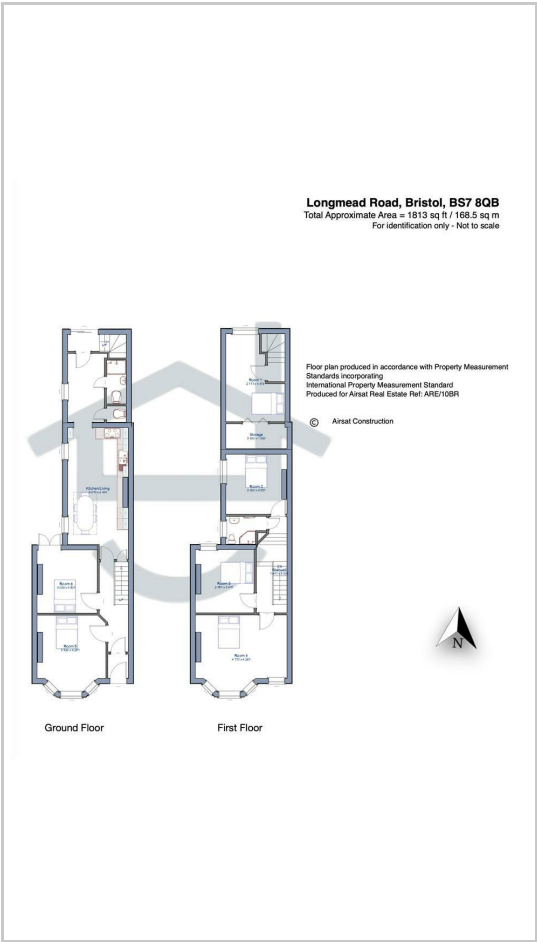

Energy Efficiency Graph

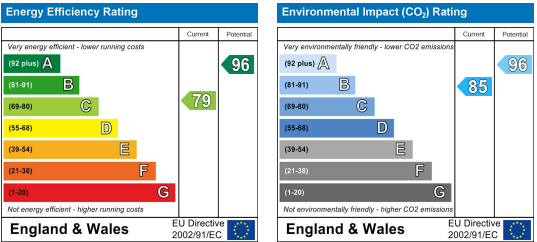

These particulars, whilst believed to be accurate are set out as a general outline only for guidance and do not constitute any part of an offer or contract. Intending purchasers should not rely on them as statements of representation of fact, but must satisfy themselves by inspection or otherwise as to their accuracy. No person in this firms employment has the authority to make or give any representation or warranty in respect of the property.

